

SMT Power Inductor (MOLDING TYPE)

MPL10X Type

Features

- RoHS compliant.
- Low profile, high current SMD type.
- Frequency range up to 1MHz.
- Lowest DCR/ μ H, in this package size.
- Low buzz noise due to its gap-less structure.

Applications

- Notebook/Desktop/Server/Video Card applications.
- High current POL converters.
- Low profile, high current power supplies.
- Battery powered devices.
- Ideal for power source circuits, DC-DC converter.
- DC-AC inverters inductor application.

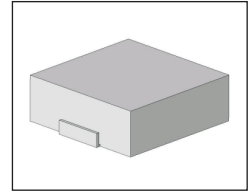

Mechanical Dimension:

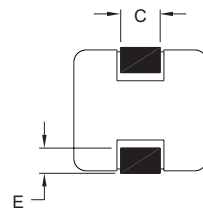
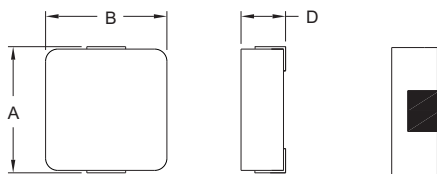

RECOMMENDED PAD PATTERNS

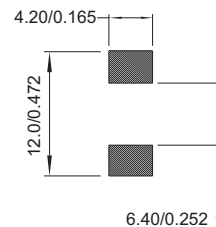

UNIT : mm/inch
 A = 11.50 / 0.452 Max.
 B = 10.00 \pm 0.30 / 0.394 \pm 0.012
 E = 2.30 / 0.091

Electrical Characteristics: At 25°C: 100KHz, 0.25V

PART NO.	Lo ¹ (μ H)	DCR (m Ω) TYP.	DCR (m Ω) MAX.	Isat ¹ (A dc)	Ir ² (A dc)	Dimension "C" mm / inch \pm 0.5 / \pm 0.02	Dimension "D" mm / inch MAX
MPL104-0R2	0.20 \pm 20%	0.75	0.90	40	32	3.5 / 0.138	4.0 / 0.157
MPL104-R33	0.33 \pm 20%	1.00	1.20	35	30	3.5 / 0.138	4.0 / 0.157
MPL104-0R4	0.40 \pm 20%	1.05	1.20	32	30	3.5 / 0.138	4.0 / 0.157
MPL104-0R5	0.50 \pm 20%	1.50	1.70	32	28	3.5 / 0.138	4.0 / 0.157
MPL104-0R6	0.60 \pm 20%	1.50	1.70	30	28	3.5 / 0.138	4.0 / 0.157
MPL104-0R9	0.90 \pm 20%	2.30	2.50	27	25	3.0 / 0.118	4.0 / 0.157
MPL105-1R0	1.00 \pm 20%	2.30	2.50	35	25	3.0 / 0.118	5.0 / 0.197

1. Isat is the DC current which cause the inductance drop approximately 30% of its nominal inductance without current.
2. Ir is the DC current which cause the surface temperature of the part increase approximately than 40°C.



DELTA ELECTRONICS, INC.

(TAOYUAN PLANT CPBG) 252, SAN YING ROAD, KUEISAN INDUSTRIAL ZONE, TAOYUAN SHIEN, 333, TAIWAN, R.O.C.

TEL: 886-3-3591968; FAX: 886-3-3591991

<http://www.deltawww.com>